

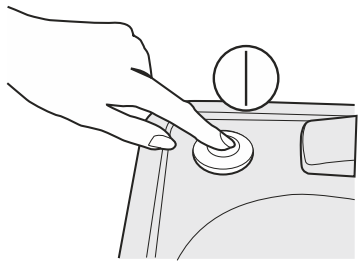

STATUS®

- Ⓒ FOOD WASTE DISPOSER
PREMIUM100/150/200/300
Operating instructions
- Ⓘ DISSIPATORE DI RIFIUTI ALIMENTARI
PREMIUM100/150/200/300
Istruzioni d'uso
- Ⓓ KÜCHENABFALLENENTSORGER
PREMIUM100/150/200/300
Bedienungsanleitung
- Ⓕ BROYEUR DE DÉCHETS ALIMENTAIRES
PREMIUM100/150/200/300
Instructions d'emploi
- Ⓡ
PREMIUM100/150/200/300





11.1

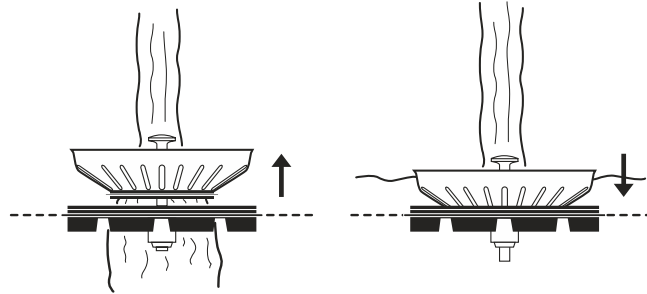

11.2

11.3

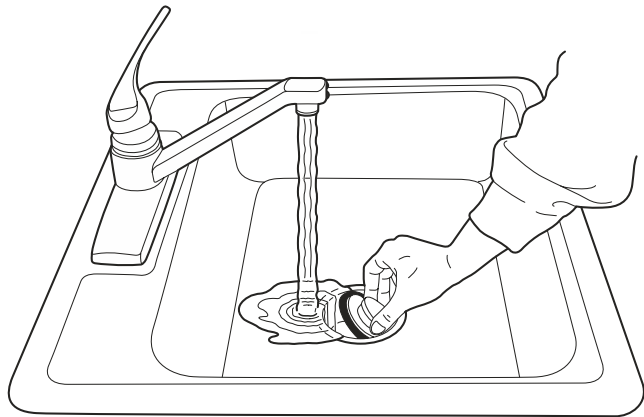

11.4

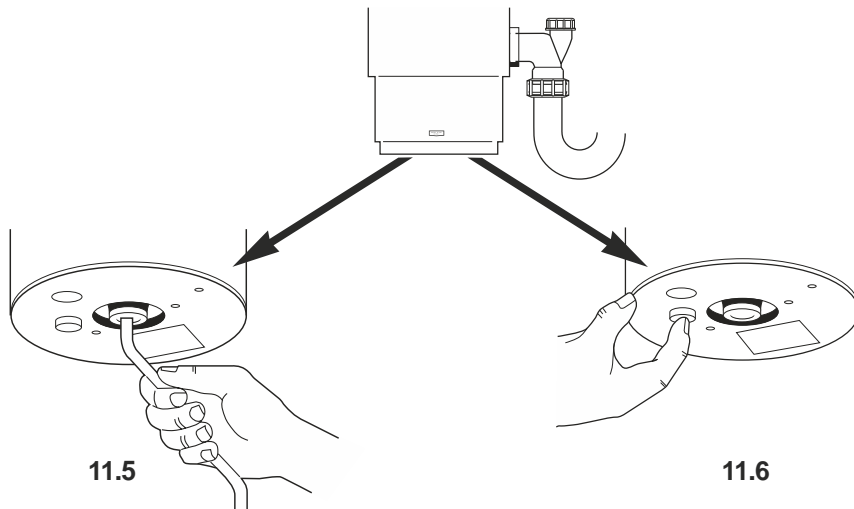

11.5

11.6

PREMIUM

PREMIUM

33

9,5

(2),

38

(.1.1)

- 1a.
- 1b.
- 2.
- 3.
- 4.
- 5.
- 6.
- 7.

(M8x40 .-. 3 .*, M8x30 .-. 3 .**)

- 9.
- 10.
- 11.
- 12.
- 13.
- 14.
- 15.

1 .))
1 .)

PREMIUM150/200/300
16.
17.
PREMIUM100
18.
19.
20.
21. (38)

(38)

(38)

- 8.
- 1.
- 1.
- 2.
- 3.
- 4.
- 5.

(.2.1)

12 .)

2.

- 1.
- 2.
- 3.
- 4.
- 5.

(1)
(2)
(3)

(4)

(.3.1).
(.3.2).

- 3.
- 1.
- 2.
- 4.

(.4.1)
(2.

(1)

.5.1.

- 1.
- 2.
- 3.
- 4.
- 5.
- 5.

(2)

(1)

() (3)
(5)

(4) ()

(2),)

(7)
(6),

- 1.
- 2.

(.6.1)

1.

2.

3.

7.

1.

2.

3.

4.

5.

8.

•

•

PREMIUM150/200/300

(.9.1).

•

•

PREMIUM100

(.9.2).

1.

2.

3.

4.

1.

9.

!

•

•

•

•

•

•

•

•

•

•

•

•

•

•

•

/

(.7.1).

(.7.2).
(.7.3).

(1)

(2). (.8.1)

(3)

(.8.2).

(.8.3)

(.9.1).

(.9.2).

(PREMIUM150/200/300)

(1). (2)
(.9.1)

(PREMIUM100)

(5)

(7). (.9.2)

(4).

(.8.2).

20

PREMIUM

33

1.

2.

3.

4.

1.

2.

3.

10.

•

•

•

•

•

•

•

•

•

•

•

•

•

•

•

•

•

•

•

•

•

3 (20 ADP/BS 3676).
20 (2). (.10.1)

(.10.2)

(.10.2)

(.10.3)

(.10.4)

(.10.2)

(.10.4)

10

!

•

•

•

•

•

•

•

•

•

•

•

•

•

•

•

•

•

•

•

•

•

PREMIUM

.11.2

.11.4.

(.8.3).

()

