

# ПРИЛОЖЕНИЕ №1

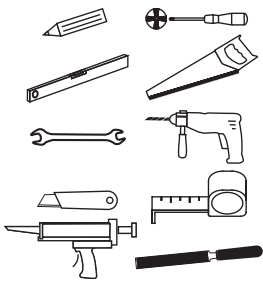
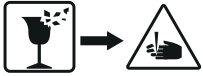
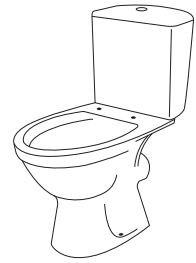

**RU** ИНСТРУКЦИЯ ПО МОНТАЖУ И ЭКСПЛУАТАЦИИ

**EN** INSTALLATION AND OPERATION MANUAL

**KZ** МОНТАЖ АНА ЭКСПЛУАТАЦИЯ БОЙЫНСА АНУСАЙЛЫҚ

**AZ** QURADIRMA VƏ İSTİSMAR TƏLİMATI

**UZ** ЙИГИШ ВА ФЙДАЛАНИШ БУЙИЧА ЙУРИҚНОМА

**GE** მონტაჟის და ექსპლუატაციის ინსტრუქცია

**AM** ՄՈՆՏԱՅԻ և ԵՃԱՅՈՐՄԱՆ ՀՐԱՆԱԳ

**TJ** ДАСТУРАМАЛ ОИДИ НАСБКУНИ ВА ИСТИФОДАБАРИ

**KG** МОНТАЖДОО ЖАНА ЭКСПЛУАТАЦИЯЛОО БОЮНЧА НУСКАМА

**1 A**

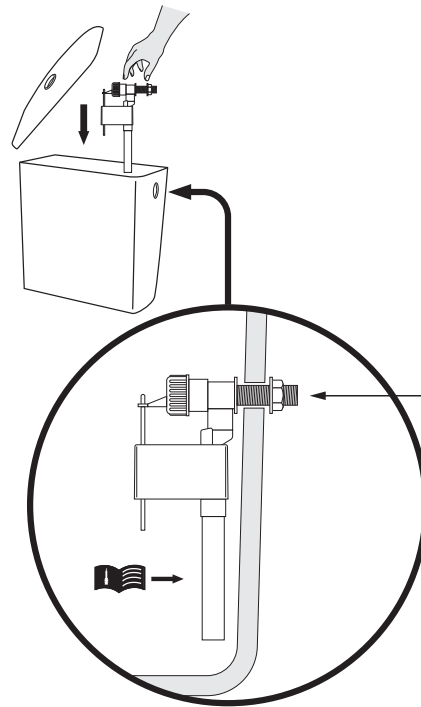

**1 B**

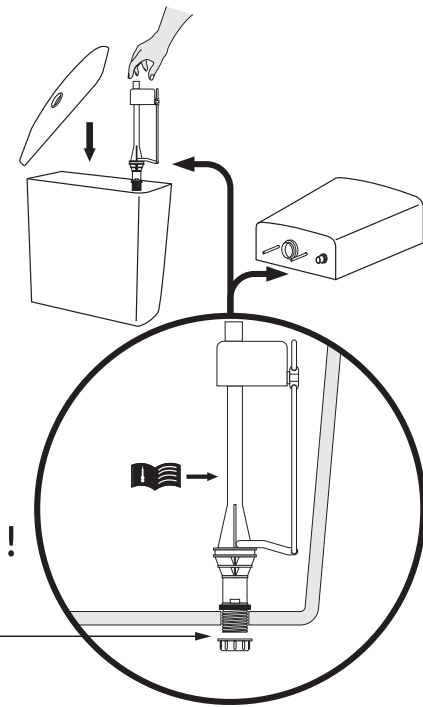

**2**

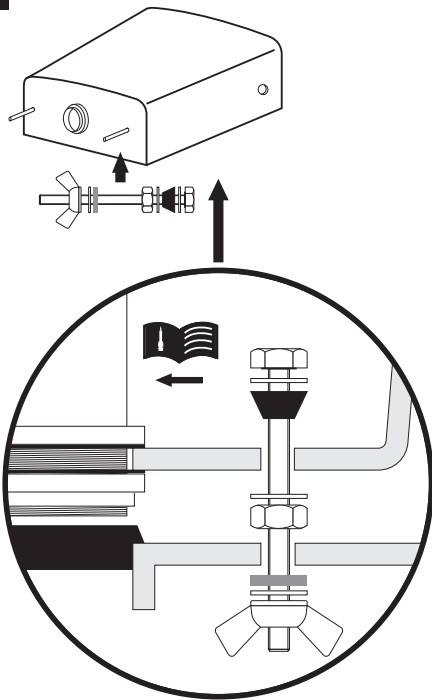

**3**

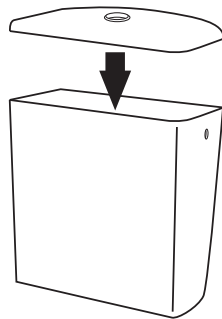

**4**

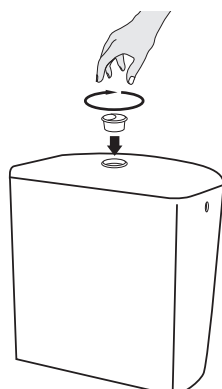

**5**

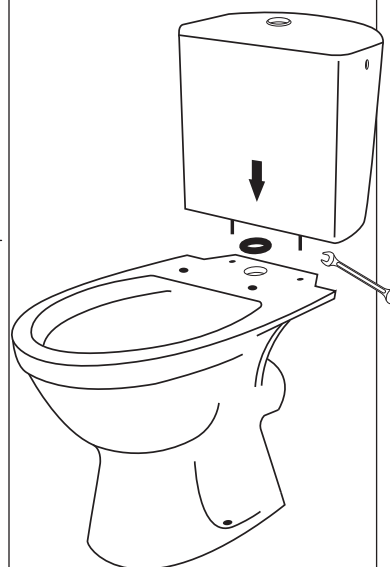

**6**

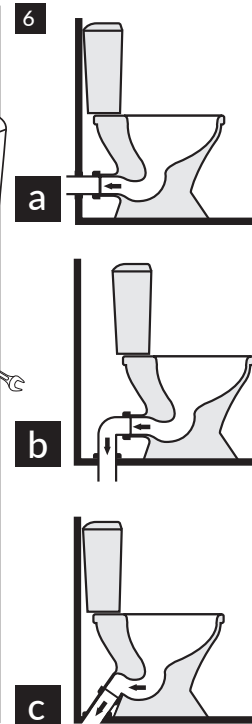

**7**

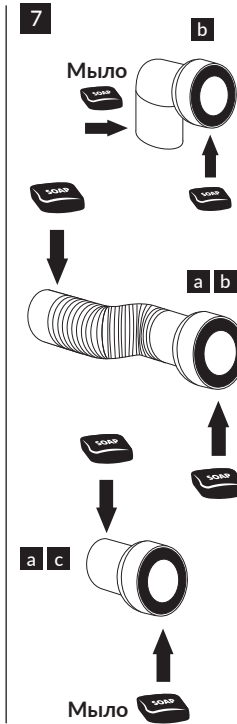

**8**

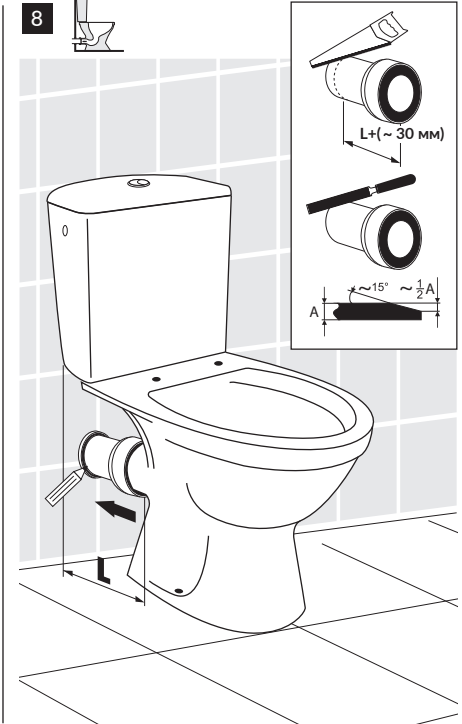

8

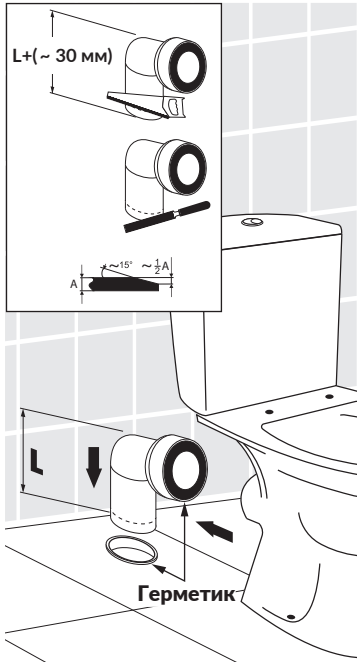

8



8

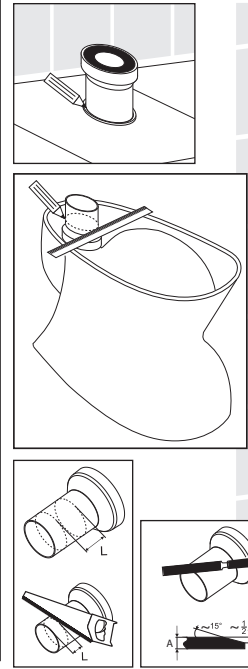

9 1

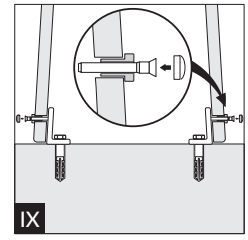
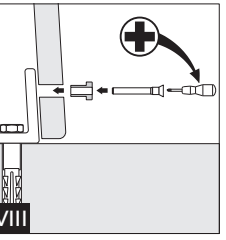
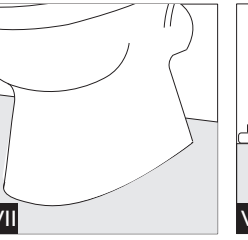
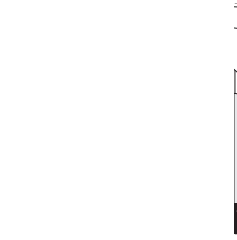
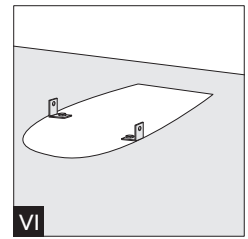
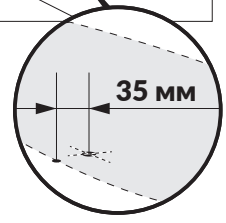
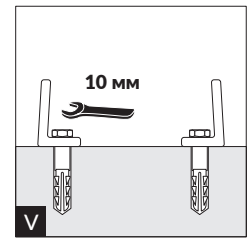
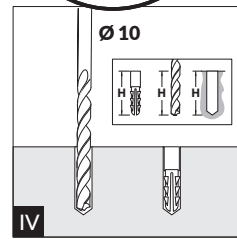
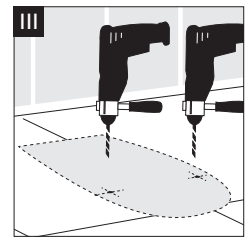
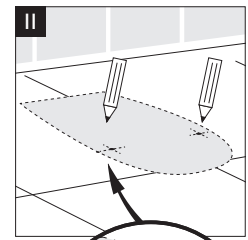
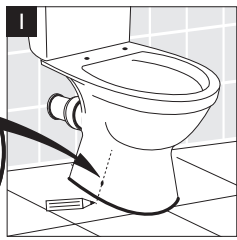
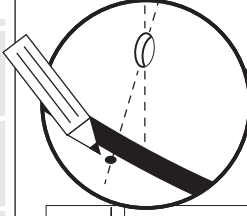

9 2

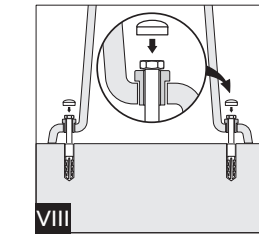
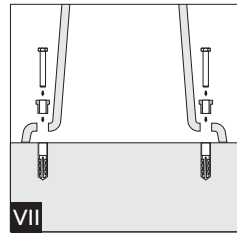
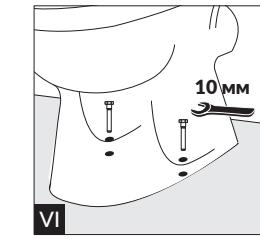
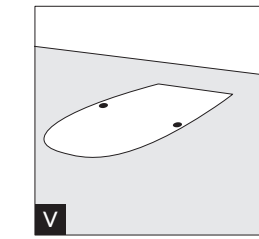
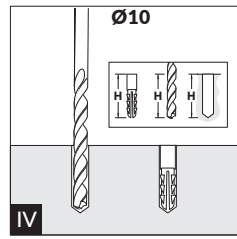
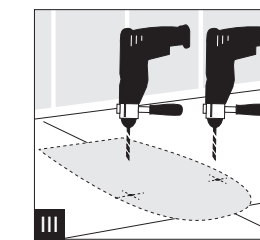
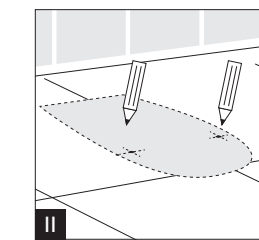

10

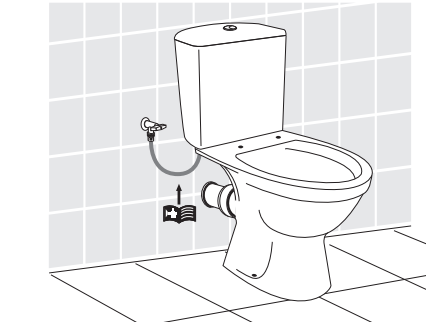
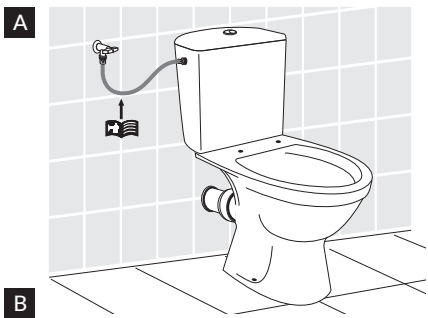
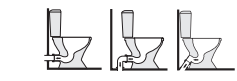

11

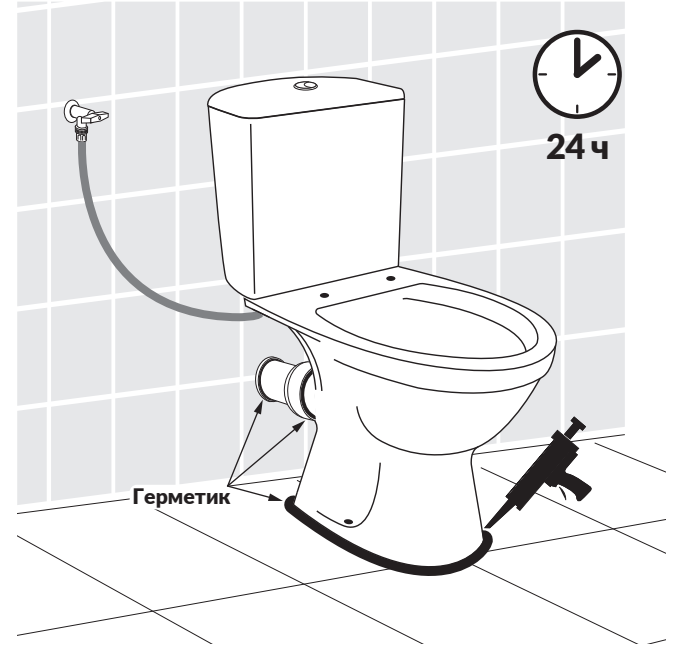

Герметик