

!  max 36M

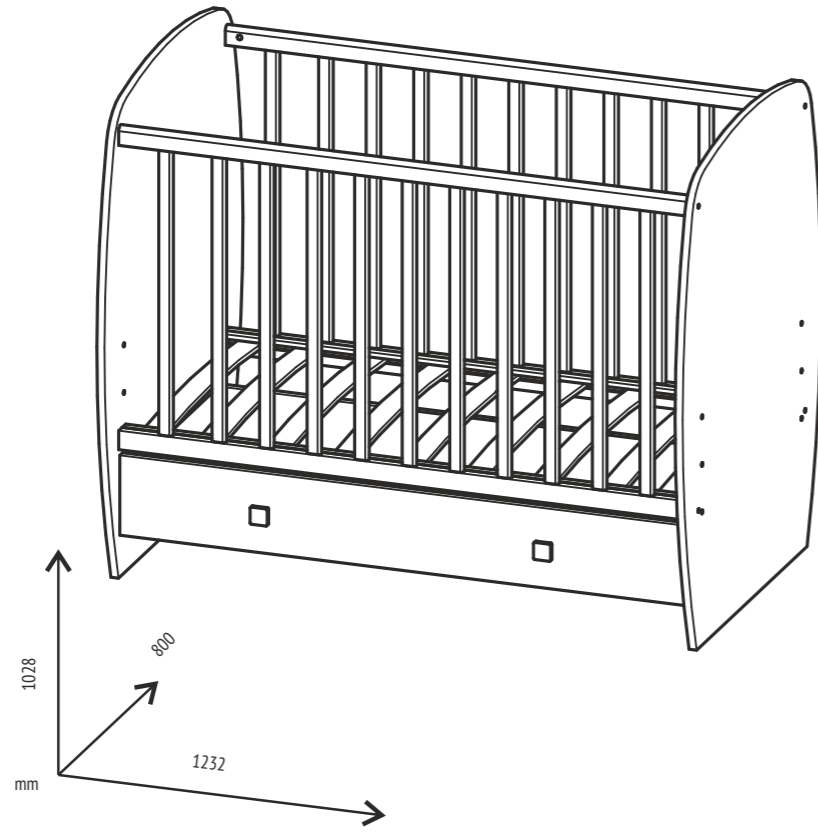

Polini kids Simple 710

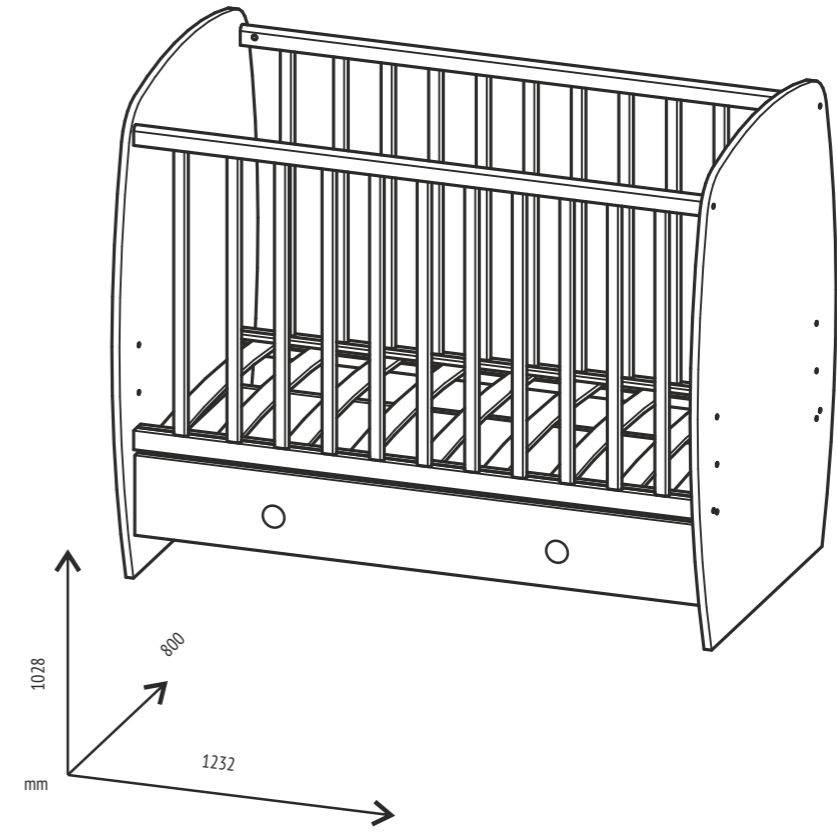

Polini kids French 710

Polini kids Simple 710
Polini kids French 710

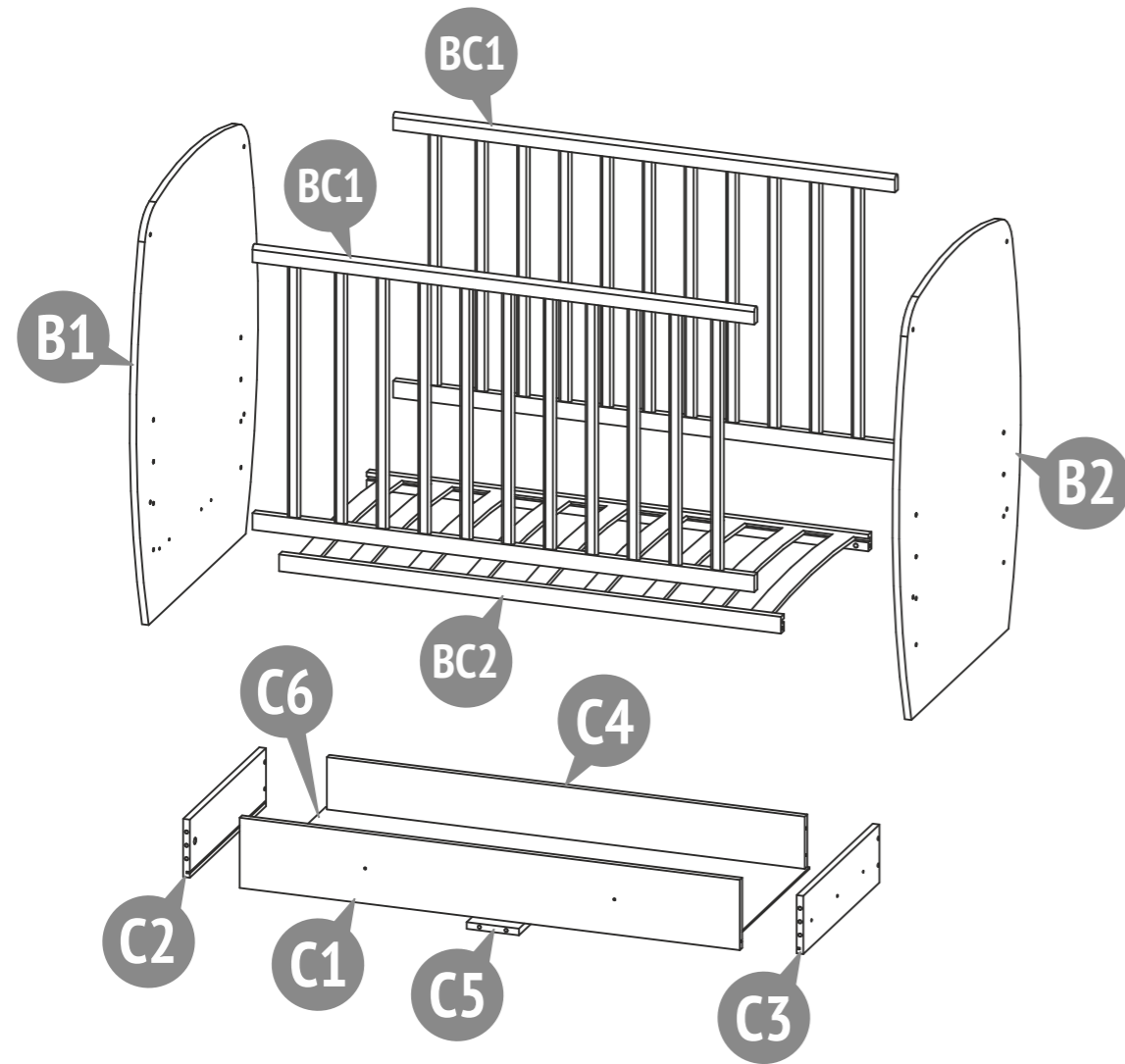

Required tools:
Erforderliche Werkzeuge:
Benodigd gereedschap:
Outils nécessaires pour le montage:

Herramientas necesarias:
Attrezzi necessari:
Ferramentas necessárias:
Необходимые инструменты:
الأدوات المطلوبة

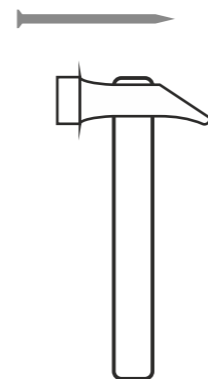

Number on the picture Nummer in der Zeichnung Nummer op figuur Número pièce Numero en el dibujo Il numero alla figura Número na figura Номер на рисунке الرقم على الرسمة	Number of parts in the product Stückzahl der Teile im Produkt Aantal componenten in het product Nombre de pièces Cantidad de elementos del producto La quantità dei dettagli nel prodotto Quantidade de peças Количество деталей в изделии كمية الأجزاء بالمنتج	Parts description Bezeichnung Onderdelen namen Description	Nombre de los elementos La nomenclatura dei dettagli Designação das peças Наименование деталей تسمية الأجزاء	Laying / Verpackug / Pakking / Packaging		El embalaje / Posa / Estilo / Укладка		ترتيب	
				Box / Karton / Plaats / Carton / Lugar / Il posto / Espaço / Место		المكان		1	2
B1	1	Left bed's back Kopfteil Kinderbett links Rugleuning kinderbedje links Tête du lit gauche	El cabecero izquierdo La spalliera del letto sinistra Cabeceira de cama esquerda Спинка кровати левая مسند سرير اليسار						•
B2	1	Right bed's back Kopfteil Kinderbett rechts Rugleuning kinderbedje recht Tête du lit droite	El cabecero derecho La spalliera del letto destra Cabeceira de cama direita Спинка кровати правая مسند سرير حق						•
C1	1	Drawer front Schubladenfront De voorkant van de lade Façade du tiroir	La fachada del cajón La facciata del cassetto Fachada da gaveta Фасад ящика واجهة الدرج			•			
C2	1	The left side wall of the drawer Die linke Seitenwand der Schublade De linker zijkant van de lade Côté gauche tiroir	Pared lateral izquierda del cajón La parete sinistra a fianco del cassetto Parede lateral da gaveta esquerda Боковая стенка ящика левая الجدار الجانبى الأيسر للدرج			•			
C3	1	The right side wall of the drawer Die rechte Seitenwand der Schublade De rechter zijkant van de lade Côté droit tiroir	Pared lateral derecha del cajón La parete destra a fianco del cassetto Parede lateral da gaveta direita Боковая стенка ящика правая الجدار الجانبى الأيمن للدرج			•			
C4	1	The rear wall of the drawer Schubladenrückwand De achterwand van de lade Côté arrière tiroir	La pared trasera del cajón La parete posteriore del cassetto Parede traseira da gaveta Задняя стенка ящика الجدار الخلفى من الدرج			•			
C5	1	Bar Leiste Bar Traverse dessous tiroir	Barra Barra Barrinha Брусок بار			•			
C6	1	Drawer bottom Schubladenboden Ladebodem Fond du tiroir	El fondo del cajón Il fondo del cassetto Fundo da gaveta Дно ящика قاع الدرج			•			
BC1	2	Cot bed's side Seitenschutz De achterkant van het kinderbedje Galeries latérales	La guía lateral Barriera da fianco Barra de segurança Боковое ограждение جانب السرير			•			
BC2	1	Cot bed's bottom Lattenrost De onderkant van het kinderbedje Sommier	El fondo de la cuna Il fondo del letto Estrado de cama Дно кровати قاع السرير			•			
	1	Set of fittings Satz Beschläge Hang-en-sluitwerk Kit visserie d'assemblage	Conjunto de los accesorios Il completo della fornitura Kit de ferragens Комплект фурнитуры زاوية معدنية			•			



Confirmat screw 7 x 50
 Confirmat Schraube 7 x 50
 Confirmate Schroef 7x50
 Vis 7 x 50
 El tornillo de rosca gruesa 7 x 50
 Il vito confirmado 7 x 50
 Parafuso confirmat 7 x 50
 Винт-конфирмат 7 x 50
 برغي الخشب (الأوروبي) 7 x 50

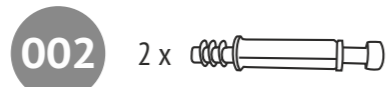

Eccentric pin
 Exzenterstift
 Stengel van excentriek
 Tige d'excentrique
 El pasador excéntrico
 La barra dell'excéntrico
 Rosca soberba
 Шток эксцентрика
 محور قرص لا متمركز (إكسنتريك)

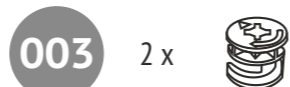

Eccentric
 Exzenter
 Excentriek
 Excentrique
 El excéntrico
 L'excéntrico
 Tambor
 Эксцентрик
 قرص لا متمركز (إكسنتريك)



Dowel 8 x 30
 Holzdübel 8 x 30
 Pluggen 8x30
 Cheville 8 x 30
 La clavija 8 x 30
 La spina 8 x 30
 Caviha 8 x 30
 Шкант 8 x 30
 دَسار 8 x 30

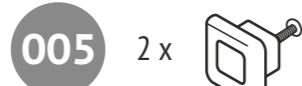

POLINI Simple 1270 Button handle
 Griff Knopf
 Knop handvat
 Poignée-bouton
 La manija-botón
 Manica-bottone
 Puxador
 Ручка-кнопка
 مقبض زر
 POLINI French 1270



Screw 6 x 13
 Holzschraube 6 x 13
 Schroef 6 x 13
 Vis 6 x 13
 El tornillo 6 x 13
 La vite 6 x 13
 Parafuso 6 x 13
 Шуруп 6 x 13
 فِلاووظ 6 x 13

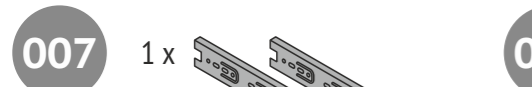

Drawer slides
 Führung
 Richtinggever
 Glissière
 Guías para cajones
 I dirigenti per i cassetti
 Correções para gavetas
 Направляющие для ящика
 عصي انزلاق للأدراج

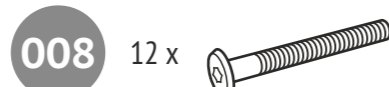

Screw M6 x 50
 Gewindeschraube M6 x 50
 Schroef M6 x 50
 Vis M6 x 50
 Tornillo M6 x 50
 Vite M6 x 50
 Parafuso M6 x 50
 Винт M6 x 50
 المسمار M6 x 50



Round nut M6
 Rundmutter M6
 Ronde moer M6
 Ecrou barillé M6
 La tuerca cilíndrica M6
 Dado barile M6
 Porca de tambor M6
 Гайка-бочонок M6
 جولة الجوز M6

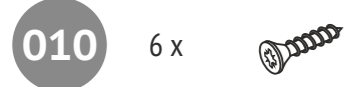

Screw 4 x 16
 Holzschraube 4 x 16
 Schroef 4x16
 Vis 4 x 16
 El tornillo 4 x 16
 La vite 4 x 16
 Parafuso 4 x 16
 Шуруп 4 x 16
 فِلاووظ 4 x 16



Screw 4 x 30
 Holzschraube 4 x 30
 Schroef 4 x 30
 Vis 4 x 30
 El tornillo 4 x 30
 La vite 4 x 30
 Parafuso 4 x 30
 Шуруп 4 x 30
 فِلاووظ 4 x 30



Nail
 Nagel
 Spijker
 Pointe
 El clavo
 Chiodo
 Prego
 Гвоздь
 مسمار



Protective cap
 Abdeckkappe
 Afsluitdop
 Vis hublot
 La tapa del tornillo de rosca gruesa
 Il tappo di chiusura per il confirmato
 Tampão para os parafusos confirmat
 Заглушка
 الأوروبي(برغي الخشب غطاء)



Rear wall mounting
 Rückwandbefestigung
 Achterwand montage
 Equer fixation fond de tiroir
 La lengüeta de la parte posterior de la pared
 Il fissatore della parete posteriore
 Fixador de parede traseira
 Фиксатор задней стенки
 مثبت الجدار الخلفي

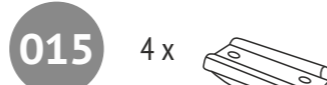

Bearing
 Fuß
 Drukklager
 Patin
 Parada
 Cuscinetto
 Rolamento
 Подпятник
 تحمل

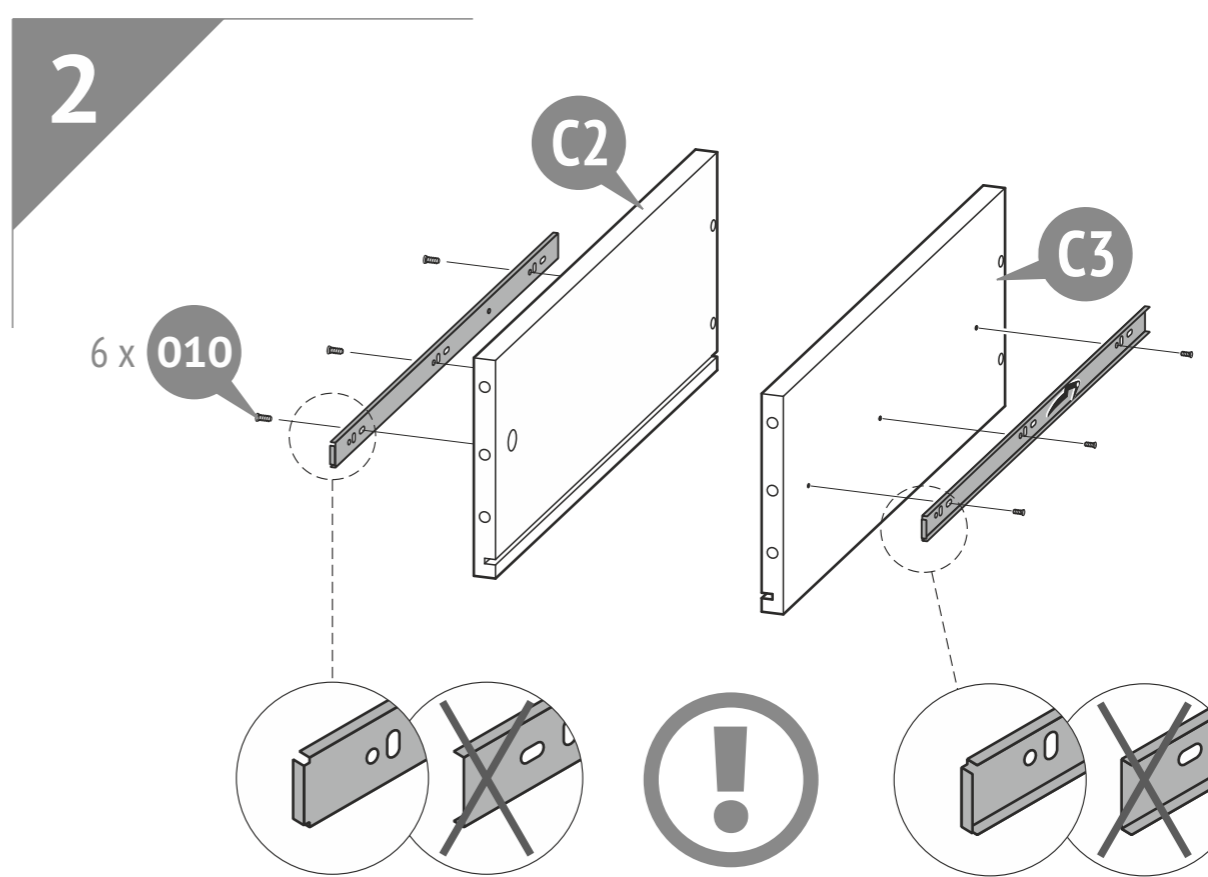
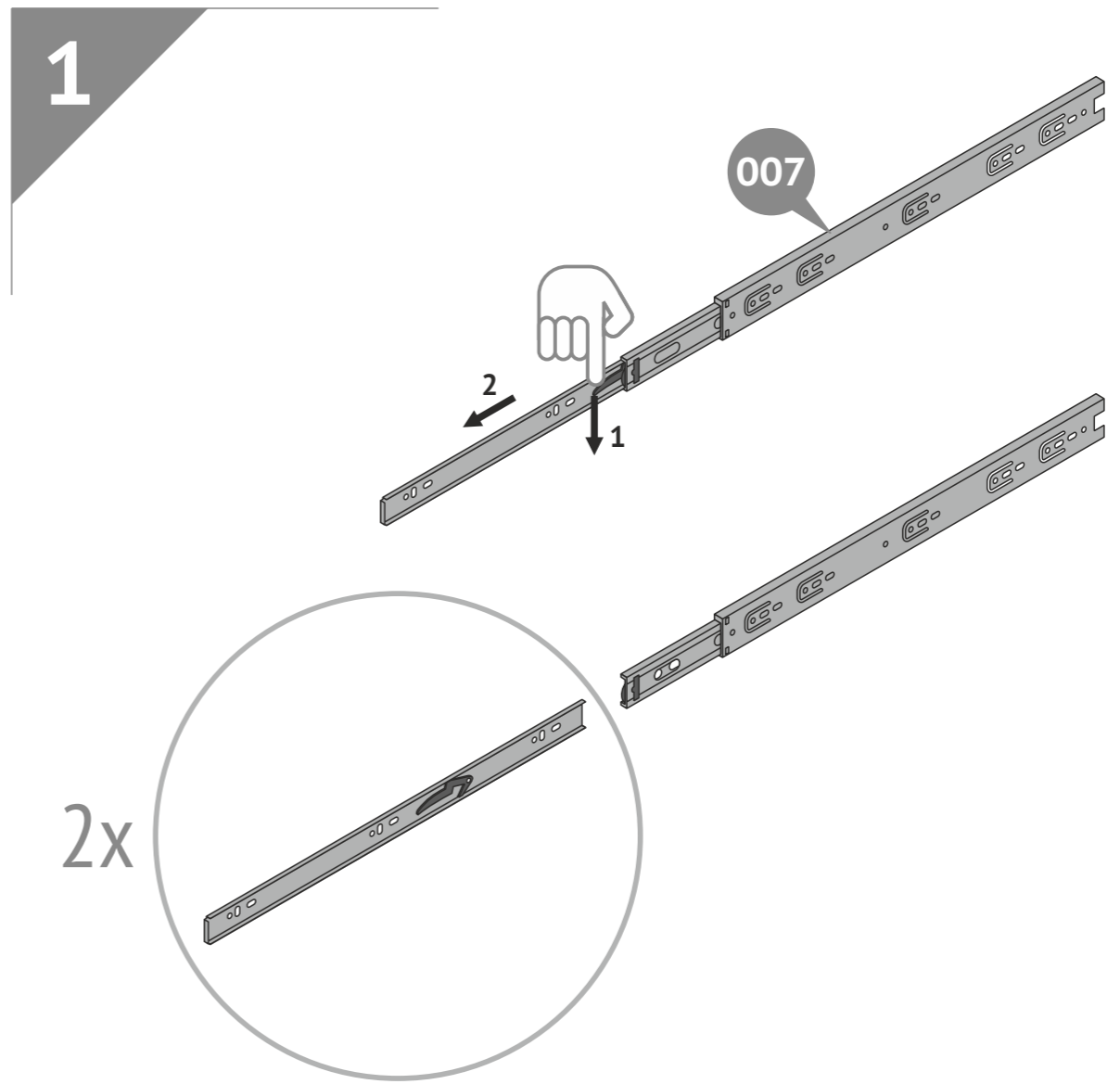

3

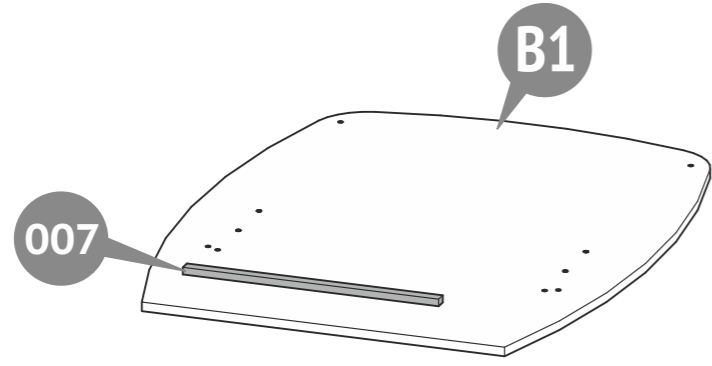

1

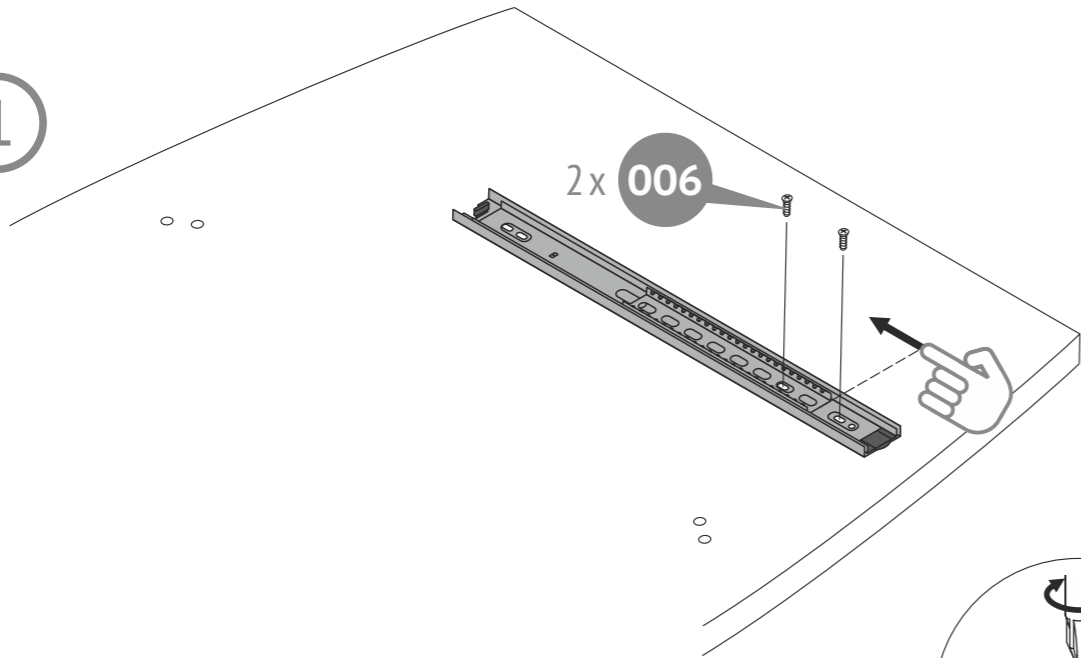

2

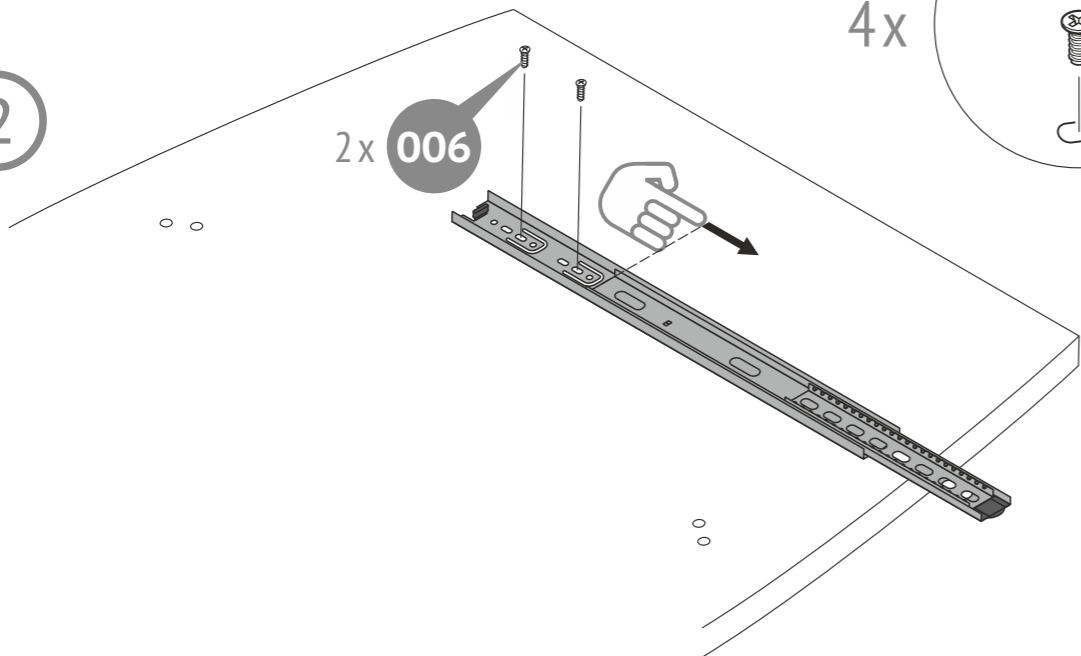

4x

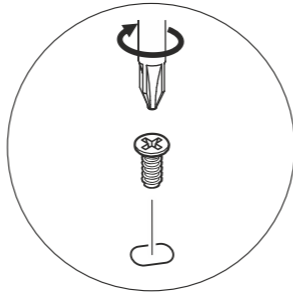

B2

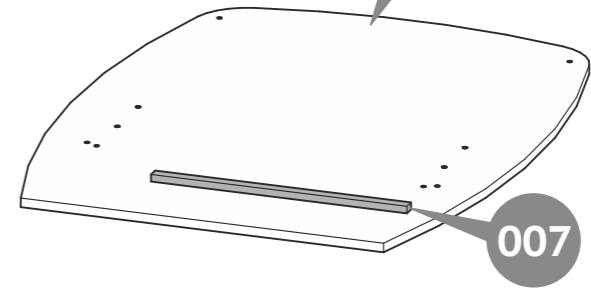

1

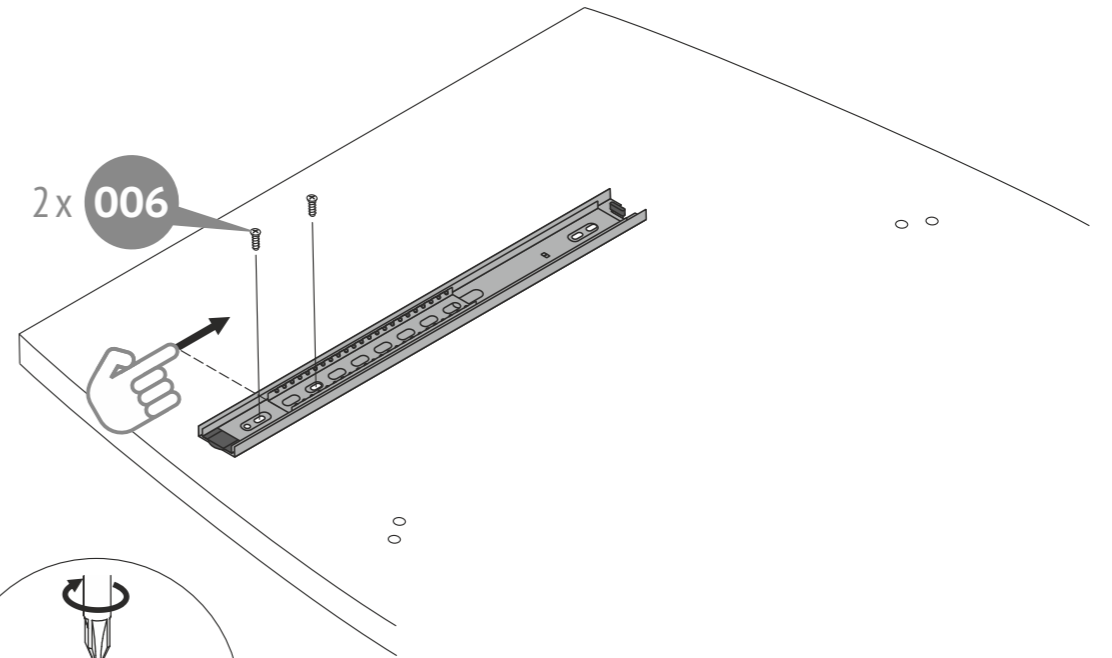

4x

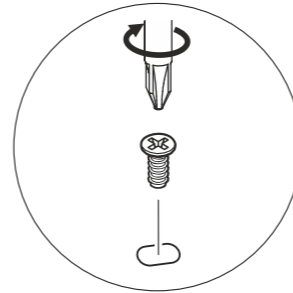

2

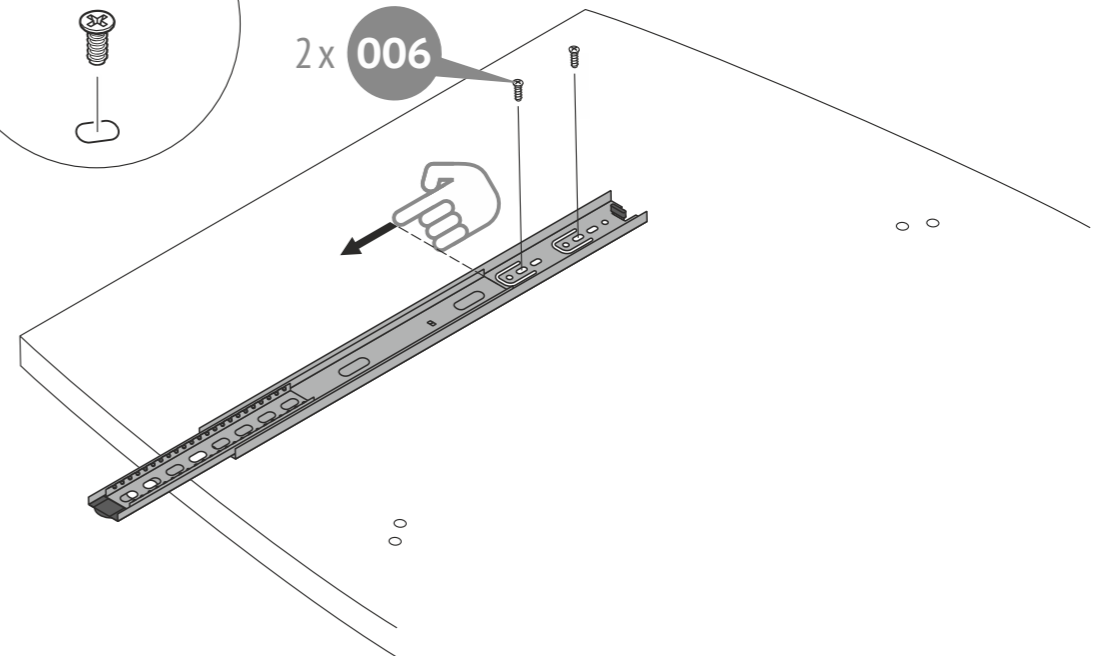

4

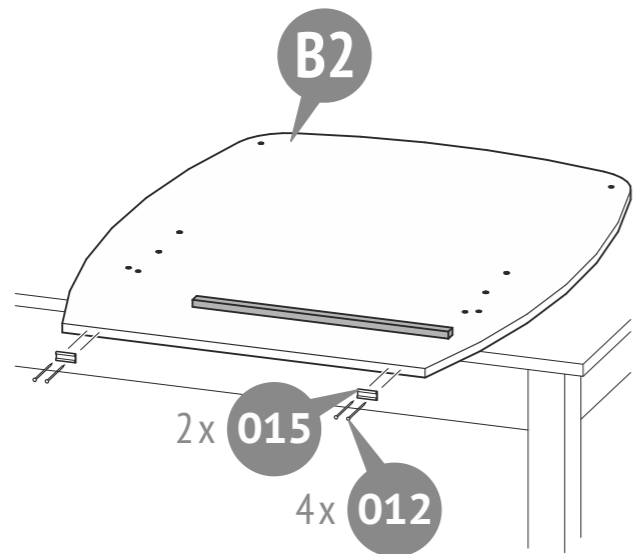
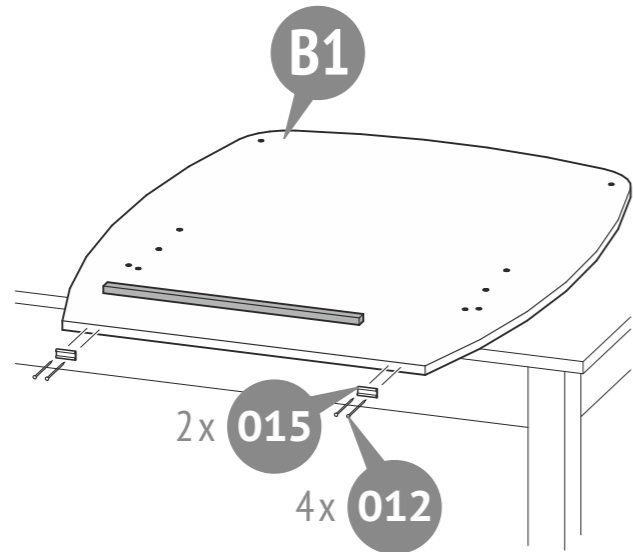
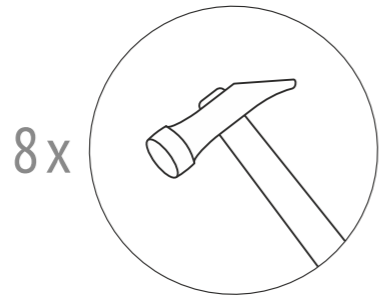

5

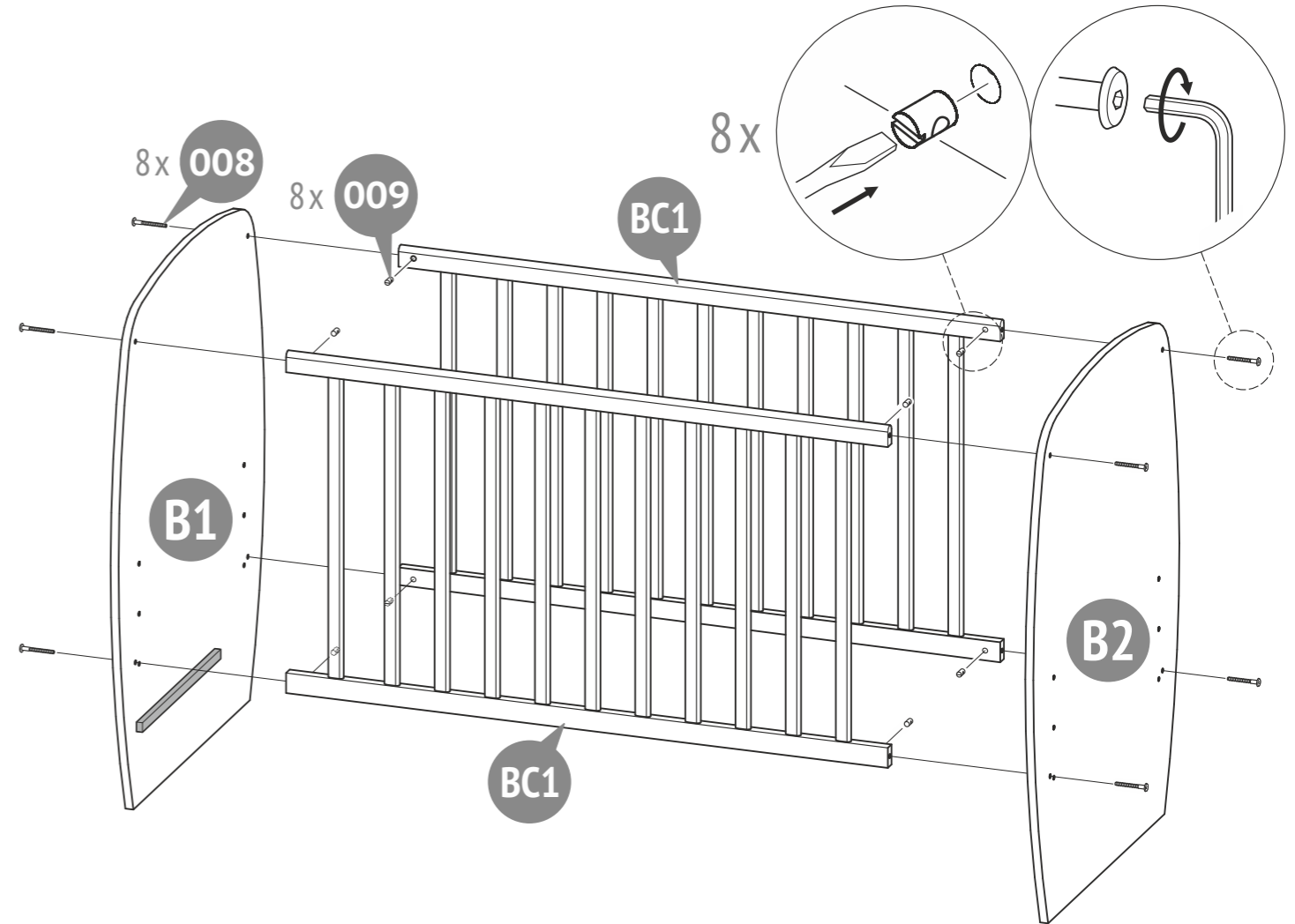

6

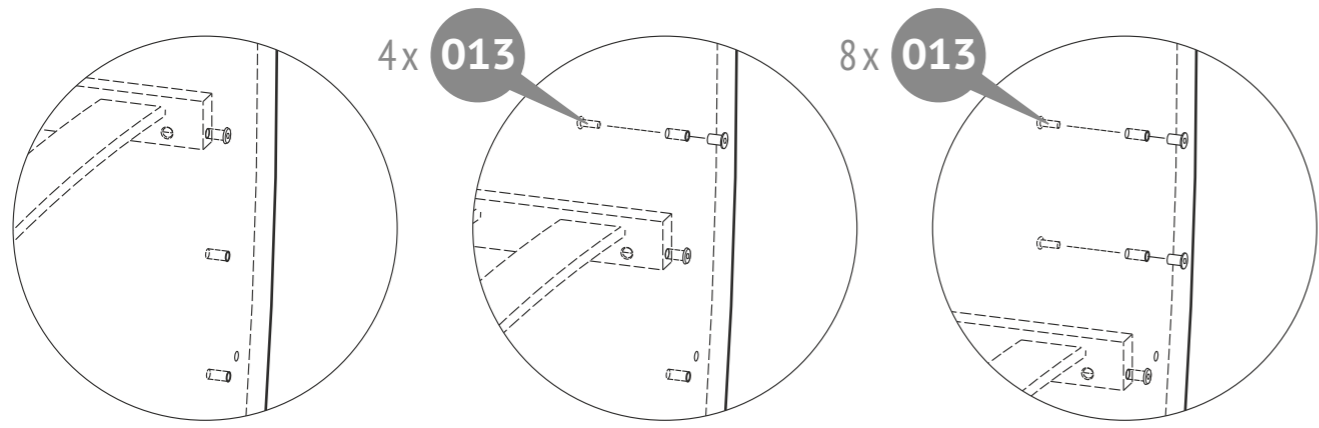
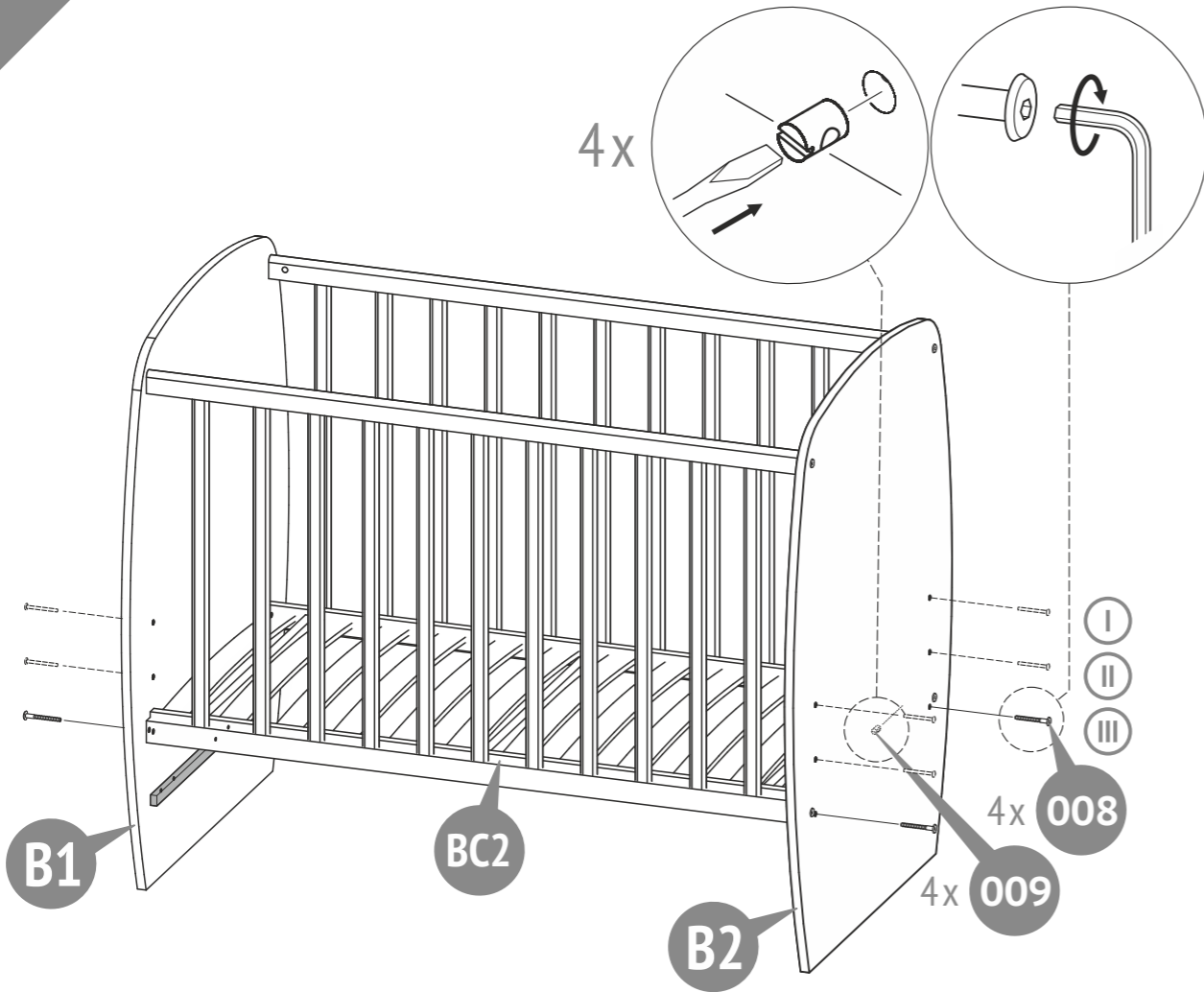

I

0-3M

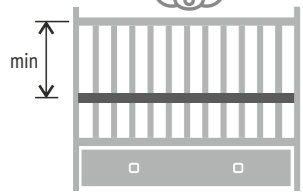

II

3-6M

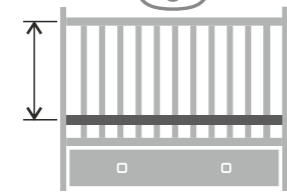

III

6M+

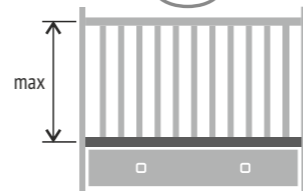

7

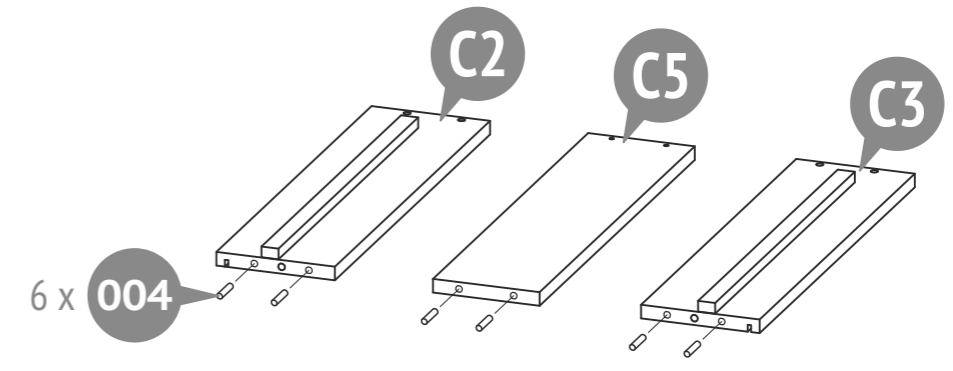

8

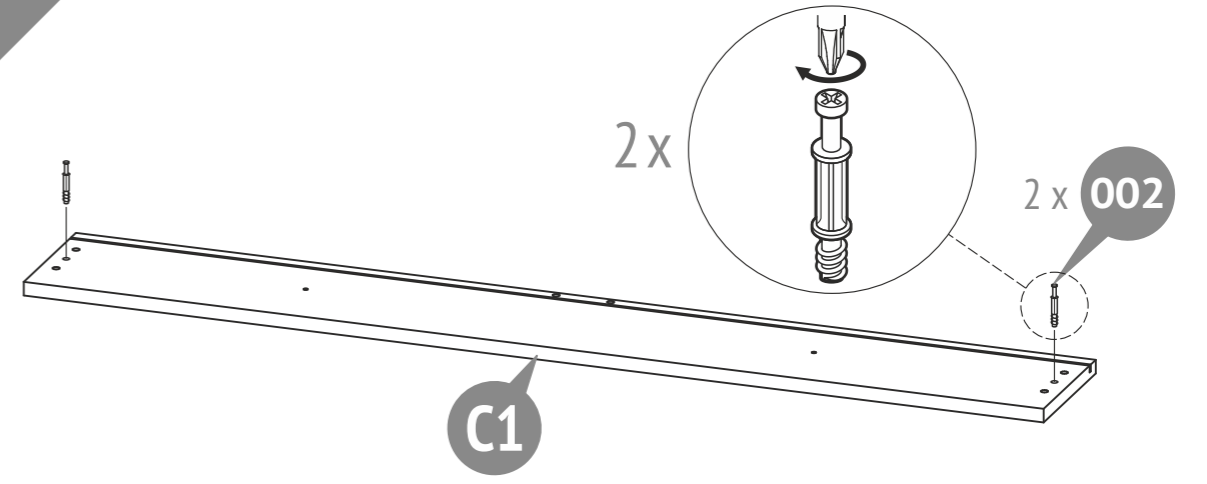

9

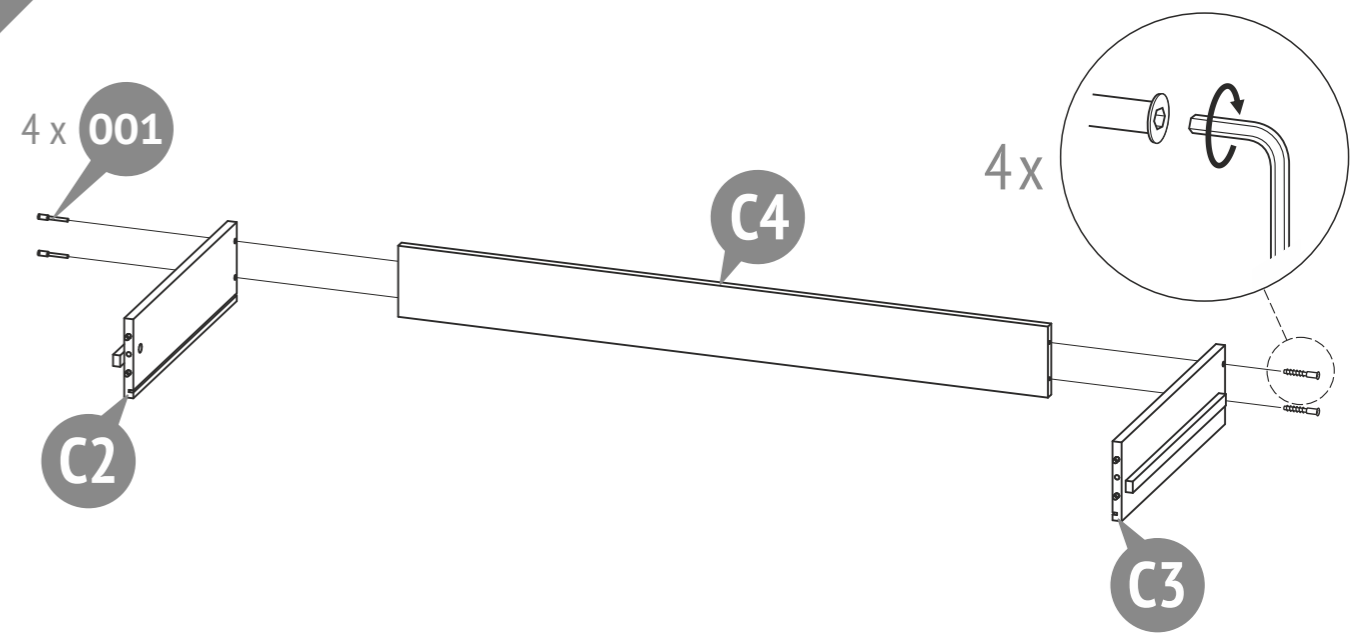

10

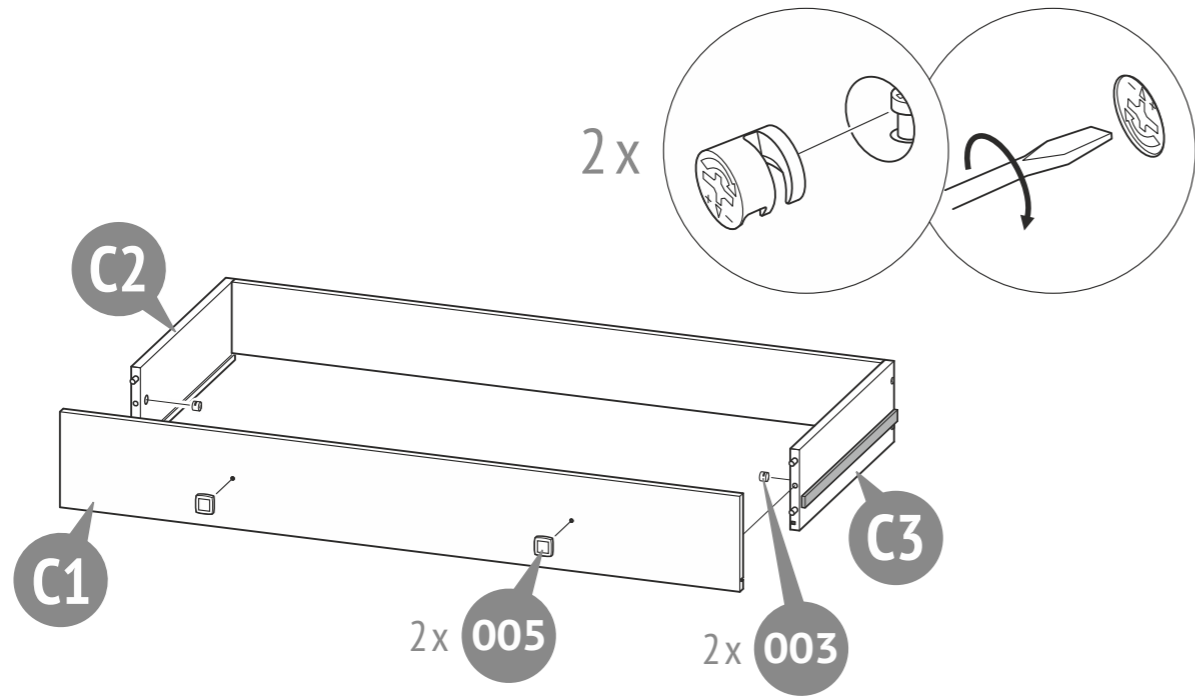

12

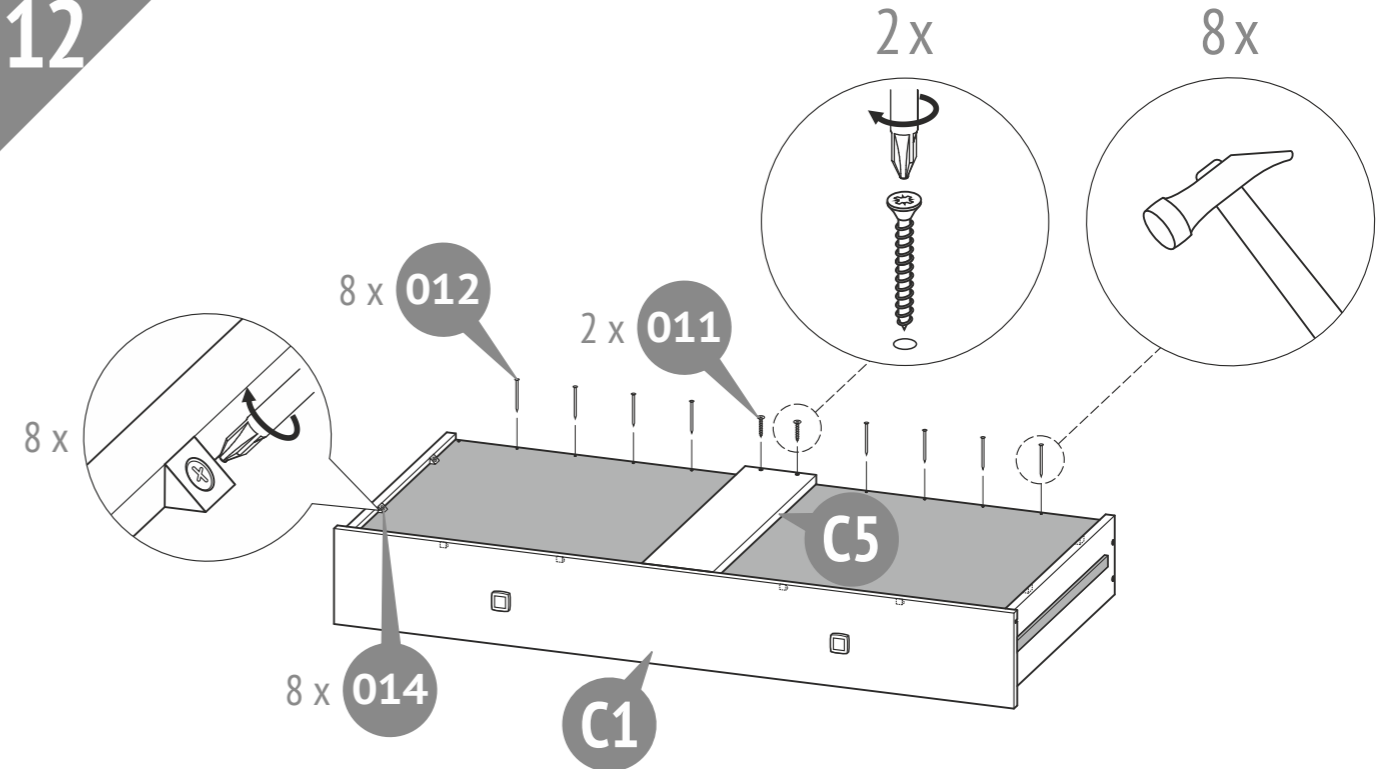

11

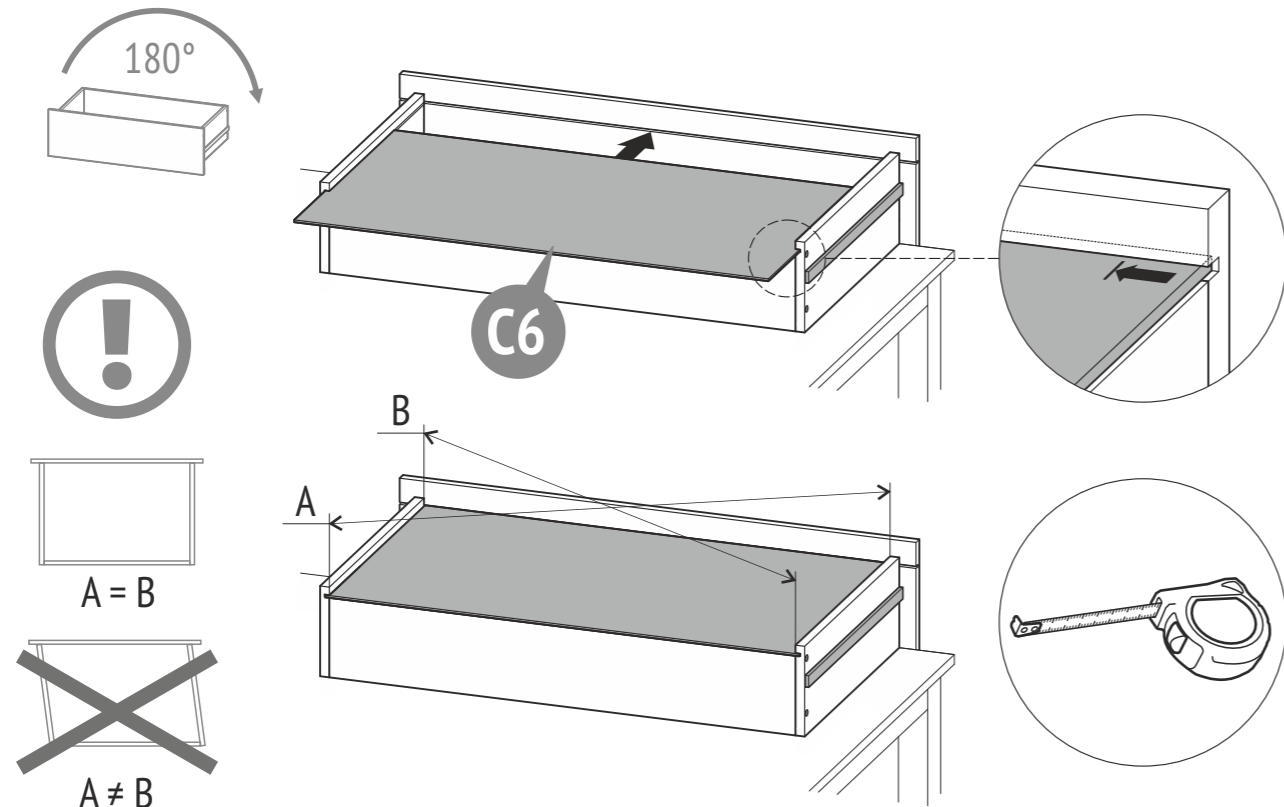

13

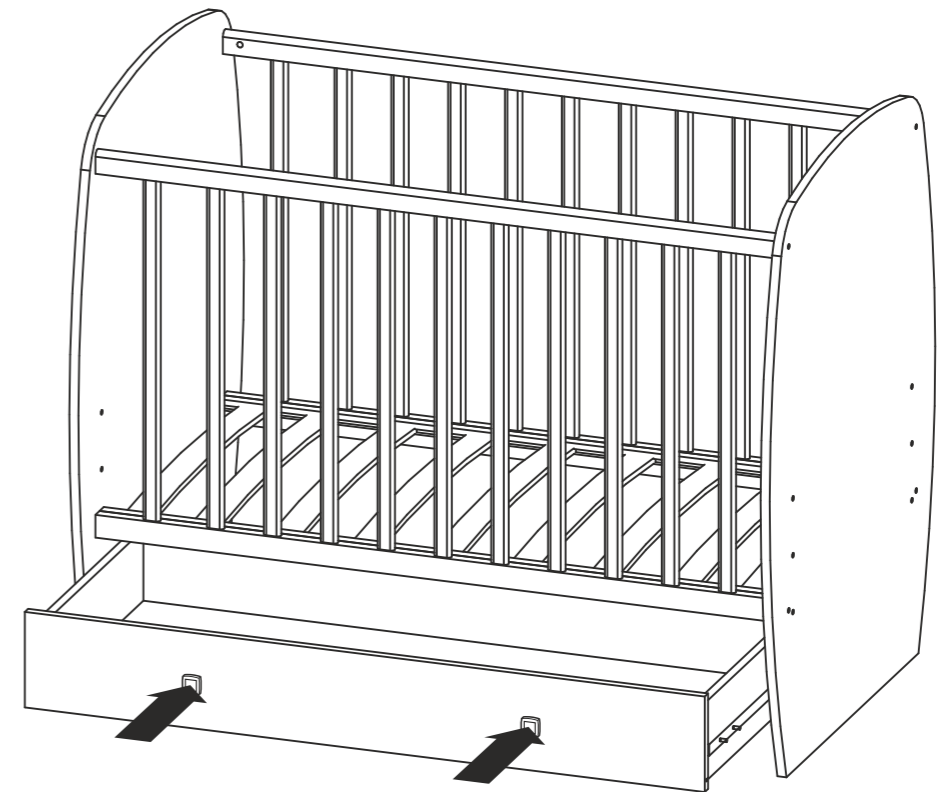

Polini kids Simple 710 / Polini kids French 710

12

13

I

0-3M

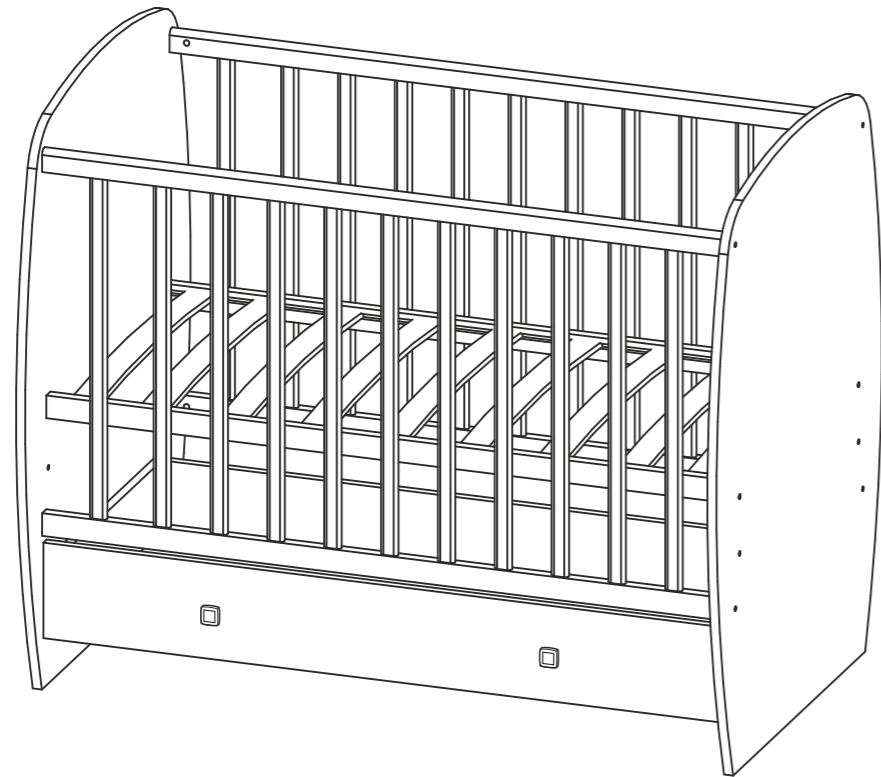

II

3-6M



III

6M+

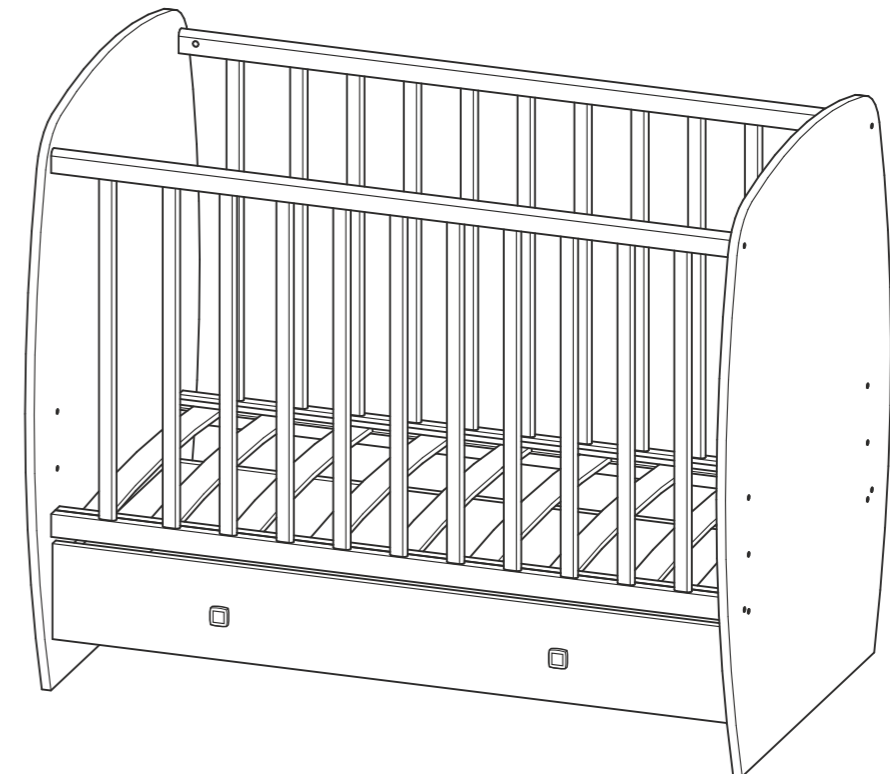

EN Recommended mattress size (LxW) - 1200 x 600 mm.
Maximum thickness of mattress - 100 mm.
Do not use more than one mattress in cot.

DE Empfohlene Matratzengröße (LxB) - 1200 x 600 mm.
Die maximale Dicke der Matratze - 100 mm.
Nie mehr als eine Matratze im Kinderbett benutzen.

NL Aanbevolen matras (LxW) - 1200 x 600 mm.
De maximale dikte van de matras - 100 mm.
Gebruik niet meer dan een matras in de babybedje.

FR Taille de matelas recommandée (LxW) - 1200 x 600 mm.
L'épaisseur maximale du matelas - 100 mm.
Ne pas utiliser plus d'un matelas dans le lit.

ES Tamaño recomendado del colchón (LxW) - 1200 x 600 mm.
El espesor máximo del colchón - 100 mm.
No utilice más de un colchón en la cuna.

IT Dimensioni consigliate del materasso (LxW) - 1200 x 600 mm.
Lo spessore massimo del materasso - 100 mm.
Non usate piu' di un materasso nel lettino.

P Tamanho recomendado do colchão (LxW) - 1200 x 600 mm.
A espessura máxima do colchão - 100 mm.
Não utilize mais do que um colchão na cama.

RU Рекомендуемый размер матраса (ДxШ) - 1200 x 600 мм.
Максимальная толщина матраса - 100 мм.
Не используйте более одного матраса в кроватке.

AE حجم المرتبة الموصى به (الطول × العرض) - 1200 × 600 مم.
الحد الأقصى لسُمك المفرش - 100 ملم.
لا تستخدم أكثر من واحد في فراش المهد.